

BALLABS CERTIFIED TEST REPORT NO.: 20539.0 DATE 07/27/18  
PREPARED FOR: IMPACT ARCHITECTURAL LIGHTING - ST. LOUIS, MO  
DESCRIPTION: 30-18 LED 4.5"ARRAYS w/FROSTED 3 PIECE .125"LENS  
49"DIA WHITE ALUM PENDANT RING w/WHITE BODY  
3 AC ELECTRONICS #AC-50CD1.4PC7 @ 850mA EA  
CATALOG NBR: P7448-40HI-NUL  
LAMP TYPE : LM-4.4-40K-80-54V

## CANDLEPOWER DISTRIBUTION

VERT ANG	AVERAGE CANDELA
0	4790.
5	4781.
10	4718.
15	4627.
20	4365.
25	4131.
30	3887.
35	3577.
40	3323.
45	3006.
50	2698.
55	2318.
60	1947.
65	1539.
70	1114.
75	715.
80	380.
85	91.
90	9.

## ZONAL LUMENS

456.4
1311.7
1912.3
2247.0
2328.3
2079.8
1528.0
756.8
98.8

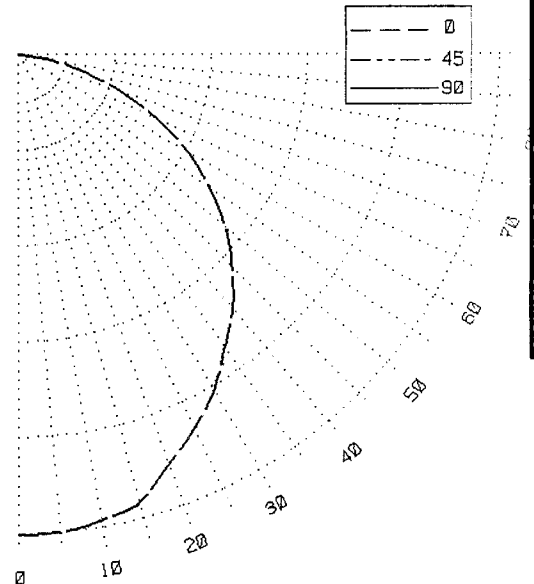

*Handwritten signature*

**NVLAP<sup>®</sup>**  
TESTING

NVLAP LAB CODE 200921-0

## LUMEN SUMMARY

ZONE	LUMENS	%LAMP	%FIXT	ZONE	LUMENS	%LAMP	%FIXT
0- 30	3680.	NA.	28.9	90-120	0.	NA.	.0
0- 40	5927.	NA.	46.6	90-130	0.	NA.	.0
0- 60	10335.	NA.	81.3	90-150	0.	NA.	.0
0- 90	12719.	NA.	100.0	90-180	0.	NA.	.0
TOTAL LUMINAIRE =				0-180	12719.	NA.	100.0

IES SPACING CRITERIA: ADJACENT= 1.2 DIAGONAL= .9

THIS BALLABS REPORT WITH THE USE OF THE NVLAP LOGO SHALL NOT BE USED BY THIS CLIENT TO CLAIM PRODUCT CERTIFICATION, APPROVAL, OR ENDORSEMENT BY NVLAP, NIST, OR ANY AGENCY OF THE FEDERAL GOVERNMENT.

BALLABS CERTIFIED TEST REPORT NO.: 20539.0 DATE 07/27/18  
 PREPARED FOR: IMPACT ARCHITECTURAL LIGHTING - ST. LOUIS, MO  
 DESCRIPTION: 30-18 LED 4.5"ARRAYS w/FROSTED 3 PIECE .125"LENS  
 49"DIA WHITE ALUM PENDANT RING w/WHITE BODY  
 3 AC ELECTRONICS #AC-50CD1.4PC7 @ 850mA EA  
 CATALOG NBR: P7448-40HI-NUL  
 LAMP TYPE : LM-4.4-40K-80-54V

\*\*\*\*\*

LUMINANCES-CD/SQ-M  
 HORIZONTAL ANGLE

VERT	0
ANGLE	
45	3434.
55	3251.
65	2910.
75	2175.
85	763.

\*\*MAXIMUM BRIGHTNESSES NOT MEASURED\*\*

\*\*\*\*\*

ZONAL CAVITY COEFFICIENTS OF UTILIZATION

EFFECTIVE FLOOR CAVITY REFLECTANCE=.20

CEILING	.80				.70				.50				.30				.10		.00
WALL	.70	.50	.30	.10	.70	.50	.30	.10	.50	.30	.10	.50	.30	.10	.50	.30	.10	.00	
RCR																			
0	1.19	1.19	1.19	1.19	1.16	1.16	1.16	1.16	1.11	1.11	1.11	1.06	1.06	1.06	1.02	1.02	1.02	1.00	
1	1.10	1.06	1.02	.99	1.08	1.04	1.00	.97	.99	.97	.94	.96	.93	.91	.92	.90	.89	.87	
2	1.01	.94	.87	.82	.99	.92	.86	.81	.88	.84	.79	.85	.81	.78	.82	.79	.76	.74	
3	.93	.83	.76	.70	.91	.82	.75	.69	.79	.73	.68	.76	.71	.67	.74	.69	.66	.64	
4	.85	.74	.66	.59	.83	.73	.65	.59	.70	.64	.58	.68	.62	.58	.66	.61	.57	.55	
5	.78	.66	.57	.51	.76	.64	.56	.50	.62	.55	.50	.60	.54	.49	.59	.53	.49	.47	
6	.72	.59	.50	.44	.70	.58	.50	.44	.56	.49	.43	.54	.48	.43	.53	.47	.42	.40	
7	.66	.53	.44	.38	.64	.52	.44	.38	.50	.43	.38	.49	.42	.37	.48	.42	.37	.35	
8	.61	.47	.39	.33	.59	.47	.39	.33	.45	.38	.33	.44	.37	.33	.43	.37	.32	.30	
9	.56	.42	.34	.29	.55	.42	.34	.29	.41	.33	.28	.40	.33	.28	.39	.32	.28	.26	
10	.52	.39	.31	.25	.51	.38	.30	.25	.37	.30	.25	.36	.30	.25	.35	.29	.25	.23	

TESTED IN ACCORDANCE WITH CURRENT IES PROCEDURES

BALLABS CERTIFIED TEST REPORT NO.: 20539.0 DATE 07/27/18  
PREPARED FOR: IMPACT ARCHITECTURAL LIGHTING - ST. LOUIS, MO  
DESCRIPTION: 30-18 LED 4.5"ARRAYS w/FROSTED 3 PIECE .125"LENS  
49"DIA WHITE ALUM PENDANT RING w/WHITE BODY  
3 AC ELECTRONICS #AC-50CD1.4PC7 @ 850mA EA  
CATALOG NBR: P7448-40HI-NUL  
LAMP TYPE : LM-4.4-40K-80-54V

\*\*\*\*\*

ELECTRICAL CHARACTERISTICS 120.07V 1.2294A 147.4400W

LUMINOUS EFFICACY (LUMENS / WATTS) = 86.3

TESTED IN ACCORDANCE WITH CURRENT IES STANDARDS  
UTILIZING ABSOLUTE PHOTOMETRY PER LM-79-08

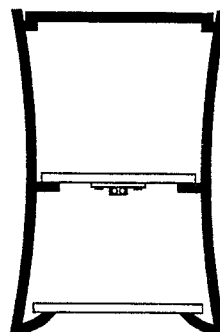
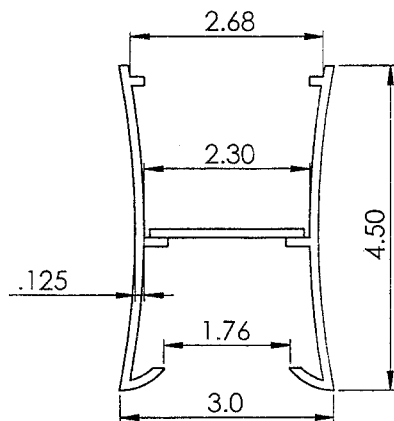

BALLABS CERTIFIED TEST REPORT NO.: 20539.0 DATE 07/27/18  
PREPARED FOR: IMPACT ARCHITECTURAL LIGHTING - ST. LOUIS, MO  
DESCRIPTION: 30-18 LED 4.5"ARRAYS w/FROSTED 3 PIECE .125"LENS  
49"DIA WHITE ALUM PENDANT RING w/WHITE BODY  
3 AC ELECTRONICS #AC-50CD1.4PC7 @ 850mA EA  
CATALOG NBR: P7448-40HI-NUL  
LAMP TYPE : LM-4.4-40K-80-54V

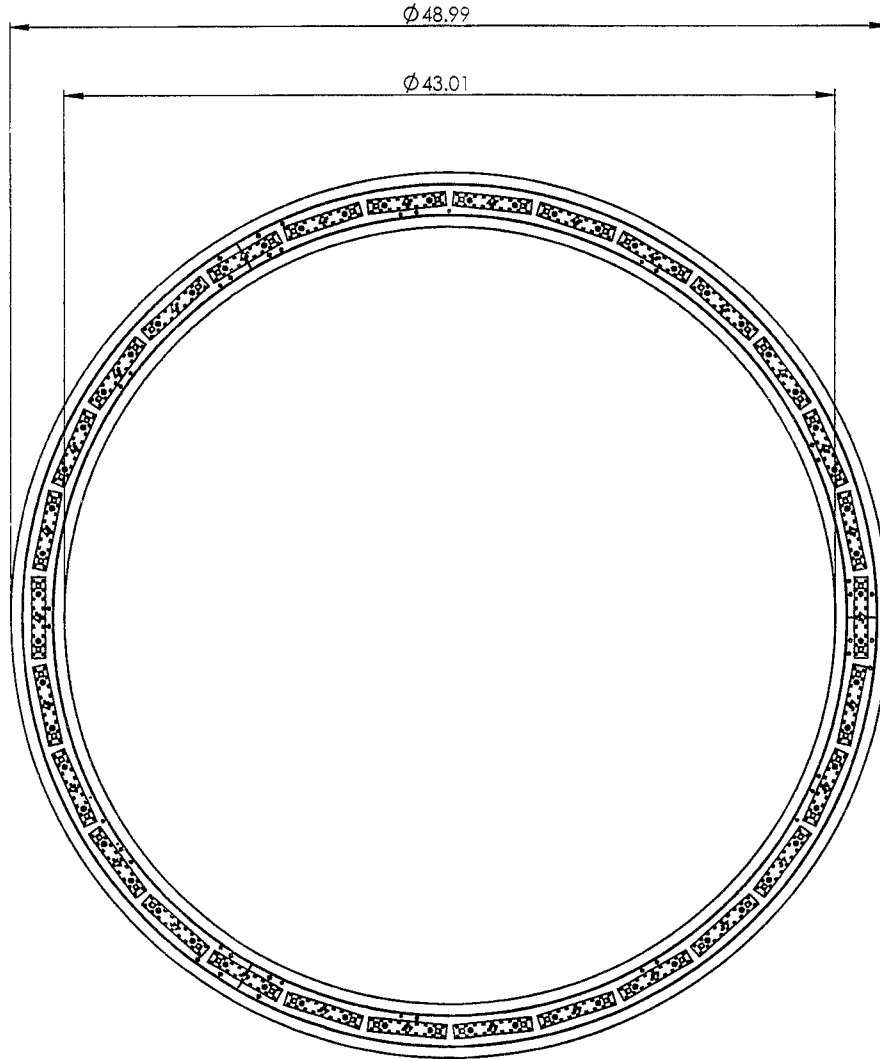

Bottom View

